

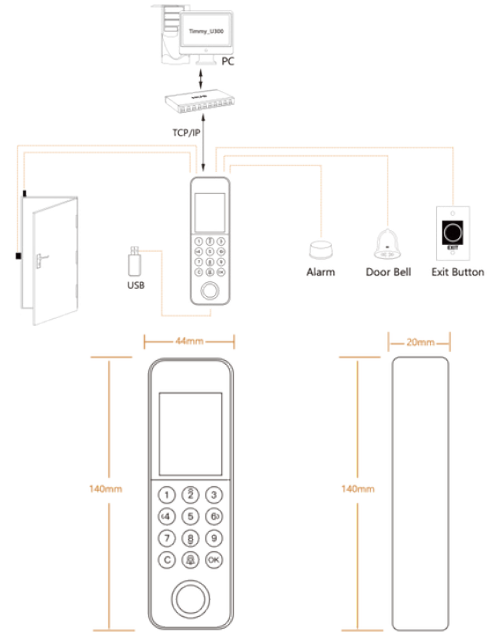

3,000 Fingerprint Capacity	200,000 Daily Reading Capacity	Multi- Language Support	2.0 inc Color Screen	USB Connection	Real Time Monitoring	Cloud Connection	Auto-Push Technology	Shift Method
----------------------------------	---	-------------------------------	----------------------------	-------------------	-------------------------	---------------------	-------------------------	-----------------



Screen	2.0 inç TFT LCD Color Display
Fingerprint Capacity	3.000 (5.000 optional)
Proximity Card Capacity	3.000 (5.000 optional) ID cards
Mifare Card Capacity	3.000 (5.000 optional) frequency 13.56MHz IC Card
Transaction Capacity	200.000
Communication	RS485, TCP/IP, USB-host
Functions	Record query, T9 login, anti-pass, anti-tamper, cloud web (ADM)
Access Control Interface	3rd party electric lock, door sensor, exit button, alarm, doorbell
Wiegand Signal	Input, Output
Optional Functions	WiFi, HID Card, External Relay
Software Development Kit	Desktop and cloud web based
Power Source	12V 3A/5A DC
Operating Temperature	0°C - 45°C
Operating Humidity	20%-80%
Dimension	140x44x20 mm
Weight	307g



Electric Lock



Magnetic Lock



Power Supply



Exit Button



Door Bell



Remote Control